

USAGE AND AFTERCARE

Shiva, Fuse and Daiya



Follow these guidelines to ensure the longevity and performance of your Tacx bottle

Suitable drinks



Max 40°

- Cold drinks** Water, sport drink, juices, milk beverages
- Warm drinks** Max 40 degrees
- Hot drink** Not suitable for drinks > 40 degrees (tea)
- Fizzy drinks** Shiva or Fuse (they have a pull-lid that blocks)
Not for the Daiya
Attn. pressure from carbonation may cause liquid to spray

Cleaning tips



- Cleaning** Use soapy water or a dishwasher max 65 degrees
Clean thorough with organic drinks
- Avoid Stains** Don't wash with heavily soiled dishes
- No Leaks** Dry the cap threads and bottle rim before closing to prevent leaking
- Freshness** Clean bottle with warm water and vinegar to eliminate odors, then rinse thoroughly
- Storage** Always store with the cap off to ensure it stays dry

Freezing or using microwave



Not suitable for freezing



Not suitable for microwave

Keep it cool

Refrigerator safe. Add ice cubes for an extra cold drink.



USAGE AND AFTERCARE



Pull-lid Daiya bottle - cleaning and replacing

Remove the Pull Lid

1. Press the pull lid to one side so that the first clip on the pull lid comes out of the cap.
2. Repeat the process on the second and third side to release all the clips and remove the entire pull lid from the cap.

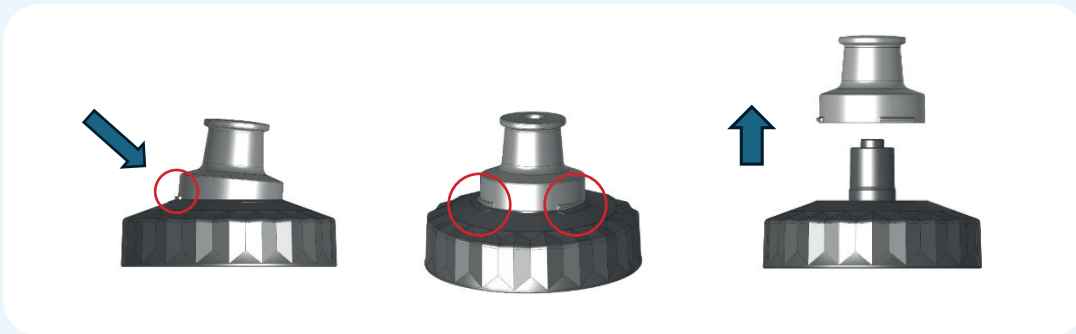

Clean the Pull Lid

1. We recommend washing the pull lid with soapy water.
2. The cap itself can be placed in the dishwasher for cleaning.

Replace the Pull Lid

1. Carefully position the clips on the pull lid to align with the markings on the cap.
2. Press the pull lid into place until it clicks into position.

